

## Your Elegant lifestyle.

Perfect for a rural location the Great Keppel incorporates the modern Australian dream home with the traditional grandeur of country manor. Entertain indoors or out with a choice of the large alfresco area, open plan kitchen/dining room or the purpose built home theatre.

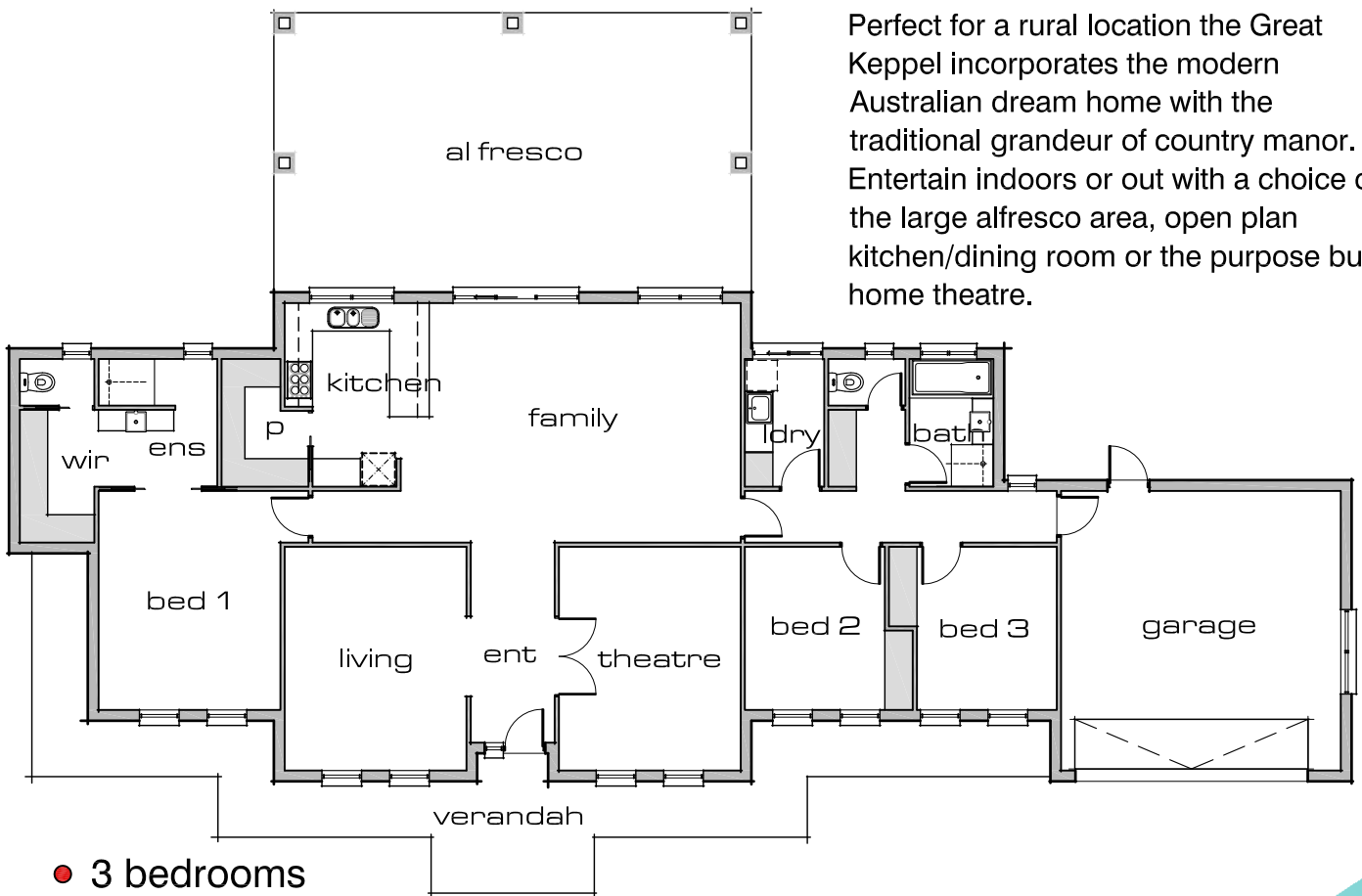

- 3 bedrooms
- theatre
- garage
- formal lounge
- al fresco / living

# the Great Keppel

35.81sq

**CONTACT:- LUKE TIERNEY**

Lifestyle Developments

P.O. Box 971 CP

Mildura Victoria 3501

Email:- [luke@lifestyledevelopments.com.au](mailto:luke@lifestyledevelopments.com.au)

**PHONE:- 0408 057 059**

dwelling - 191.55m<sup>2</sup>

garage - 41.00m<sup>2</sup>

externals - 100.18m<sup>2</sup>

total: - 332.73m<sup>2</sup>

© COPYRIGHT - 2009

*Lifestyle*  
developments

*Building a Better Life!*